

LOCATION
GOOGLE MAPS



SATELLITE VIEW
GOOGLE EARTH



TAX MAP
CT ECO MAPS



FRONT VIEW
GOOGLE STREET VIEW

1.0 GENERAL REQUIREMENTS:

1.1 PROJECT SCOPE:
RETROFIT EXISTING SUPPORT STRUCTURE.

1.2 DESIGN INTENT:
THE INVOLVEMENT OF OLIVER ENGINEERING IN THIS PROJECT IS: PROVIDE DESIGN AND DRAWINGS FOR TANK MODIFICATION.

IT IS THE INTENT OF THESE DRAWINGS TO CALL FOR COMPLETE AND FINISHED WORK, IN COMPLIANCE WITH THE NOTED CODES, AND TESTED AND GUARANTEED AND READY FOR OPERATION.

THE ENGINEER HAS NOT BEEN ENGAGED TO SUPERVISE ANY WORK AND DOES NOT HAVE CONTROL OR CHARGE OF, AND SHALL NOT BE RESPONSIBLE FOR, CONSTRUCTION MEANS, METHODS, TECHNIQUES, SEQUENCES, OR PROCEDURES, FOR SAFETY PRECAUTIONS AND PROGRAMS IN CONNECTION WITH THE WORK, FOR THE ACTS OR OMISSIONS OF THE CONTRACTOR, SUBCONTRACTOR, OR ANY OTHER PERSONS PERFORMING ANY OF THE WORK, OR FOR THE FAILURE OF ANY OF THEM TO CARRY OUT THE WORK IN ACCORDANCE WITH THE CONTRACT DOCUMENTS.

1.3 EXISTING CONSTRUCTION TYPE:
THE EXISTING BUILDING, PER THE BUILDING CODE OF CONNECTICUT STATE, TABLE 601 IS CONSTRUCTION TYPE VB - CONSTRUCTION WHERE THE PRIMARY ELEMENTS ARE NOT REQUIRED TO BE FIRE RATED.

1.4 CLASSIFICATION OF PROPOSED WORK:
THIS IS A PROPOSED REPAIR, PER THE EXISTING BUILDING CODE, SECTION 301.2, AND SHALL COMPLY WITH THE PROVISIONS OF CHAPTER 4 OF THAT CODE.

1.5 ZONING, OCCUPANCY AND USE:
INSIDE/OUTSIDE: N/A
YEAR BUILT: N/A
ZONING: R-20 SINGLE FAMILY
OCCUPANCY CLASSIFICATION: MUNICIPAL
EXISTING USE: SINGLE FAMILY
PROPOSED USE: SINGLE FAMILY (NO CHANGE)

1.6 COMPLIANCE:
ALL WORK SHALL BE IN COMPLIANCE WITH THE FOLLOWINGS CODES:
• GENERAL: 2021 INTERNATIONAL BUILDING CODE PORTION OF THE 2022 CONNECTICUT STATE BUILDING CODE (INTERNATIONAL BUILDING CODE 2021 WITH AMENDMENTS).
• EXISTING: 2021 INTERNATIONAL EXISTING BUILDING CODE PORTION OF THE 2022 CONNECTICUT STATE BUILDING CODE (INTERNATIONAL EXISTING BUILDING CODE 2021 WITH AMENDMENTS).
• ENERGY: NOT APPLICABLE TO THESE DRAWINGS.
• PLUMBING: NOT APPLICABLE TO THESE DRAWINGS.
• ELECTRICAL: NOT APPLICABLE TO THESE DRAWINGS.
• DRAINAGE: NOT APPLICABLE TO THESE DRAWINGS.
• MUNICIPAL CODE OF THE TOWN OF GREENWICH
• OTHER: ALL REFERENCED CODES, OTHER CODES AND REGULATIONS, FEDERAL, STATE AND LOCAL, THAT MAY APPLY.

1.7 AUTHORITY HAVING JURISDICTION:
THE AUTHORITY HAVING JURISDICTION, AS DEFINED IN SECTION 103.1 OF THE RESIDENTIAL CODE, AND WHICH SHALL PROVIDE FOR ADMINISTRATION AND ENFORCEMENT OF THE UNIFORM CODE AND ENERGY CODE BY LOCAL LAW, ORDINANCE, OTHER APPROPRIATE REGULATION, OR COMBINATION THEREOF, IS THE TOWN OF GREENWICH.

THE DULY APPOINTED BUILDING OFFICIAL OF THE TOWN OF GREENWICH IS AUTHORIZED TO ENFORCE THE PROVISIONS OF THE CODE.

THE BUILDING OFFICIAL MAY ADOPT POLICIES AND PROCEDURES IN ORDER TO CLARIFY THE APPLICATION OF THE PROVISIONS OF THE CODE. SUCH POLICIES AND PROCEDURES SHALL BE IN COMPLIANCE WITH THE INTENT AND PURPOSE OF THE CODE.

2.0 CONTRACTOR'S RESPONSIBILITIES:

THE CONTRACTOR SHALL:

- PROVIDE ALL LABOR, MATERIALS AND EQUIPMENT NECESSARY FOR A COMPLETE AND FINISHED JOB.
- PROVIDE ALL NECESSARY SHORING AND BRACINGS FOR ALL BUILDING COMPONENTS IN ORDER TO ADEQUATELY PROTECT AGAINST ANY FAILURES.
- OBTAIN AND PAY FOR ALL REQUIRED PERMITS - UNLESS OTHERWISE STIPULATED.
- PRIOR TO THE SUBMISSION OF ANY BID, AND BEFORE PROCEEDING WITH ANY WORK, VISIT THE SITE AND VERIFY AND FAMILIARIZE HIMSELF WITH ALL SITE DIMENSIONS AND CONDITIONS, WITH SITE WORKING CONDITIONS, HOURS OF LEGAL OPERATION, METHODS AND ROUTES OF ACCESS, AND THE EXISTENCE AND EXTENT OF ANY OTHER RESTRICTIONS, AND BE RESPONSIBLE FOR THE VERIFICATION OF ALL SUCH CONDITIONS AND DIMENSIONS WHICH PERTAIN TO THE PROJECT.
- BRING ALL DISCREPANCIES IN CONDITIONS AND DIMENSIONS, BETWEEN THE APPROVED DRAWINGS AND ACTUAL FIELD CONDITIONS, TO THE IMMEDIATE ATTENTION OF THE OWNER, AND RECEIVE DIRECTION IN WRITING, BEFORE PROCEEDING WITH THE AFFECTED WORK.
- VERIFY THE AVAILABILITY, LOCATION LAYOUT AND CONDITION OF UTILITIES, INCLUDING SEWER, WATER, GAS AND ELECTRIC LINES, PRIOR TO THE SUBMISSION OF ANY BID.
- HAVE CONTROL OVER AND SUPERVISE AND DIRECT THE WORK, INCLUDING THAT OF ITS SUBCONTRACTORS, AND BE SOLELY RESPONSIBLE FOR CONSTRUCTION MEANS, METHODS, TECHNIQUES, SEQUENCES AND PROCEDURES, AND FOR JOBSITE SAFETY, AND FOR COORDINATING ALL PORTIONS OF THE WORK UNDER THE CONTRACT.
- PRIOR TO THE COMMENCEMENT OF ANY WORK, VERIFY THE CONDITION OF ALL ADJOINING STRUCTURES WHICH MAY BE AFFECTED, AND PROVIDE ADEQUATE PROTECTION TO ANY STRUCTURE THAT MIGHT BE OTHERWISE AFFECTED.
- IN THE EVENT THAT DAMAGE IS CAUSED TO ANY STRUCTURE, FINISH, OR OTHER ELEMENT, RESTORE SUCH ELEMENTS TO THEIR ORIGINAL CONDITION.
- IF APPLICABLE, PROVIDE WEATHER PROTECTION, IN AN EFFECTIVE AND TIMELY MANNER, TO PROTECT THE PREMISES, PERSONNEL, MATERIALS AND INSTALLED WORK.
- BE A HOME IMPROVEMENT CONTRACTOR WITH A CURRENT LICENSE ISSUED BY THE DEPARTMENT OF CONSUMER PROTECTION OF THE STATE OF CONNECTICUT.
- BE CERTIFIED AS A LEAD SAFE FIRM BY THE EPA PER 40 CFR 745.226.
- CARRY LIABILITY INSURANCE TO THE LIMITS REQUIRED BY THE AUTHORITY HAVING JURISDICTION AND ISSUE CERTIFICATE(S) OF INSURANCE AS REQUIRED BY THE HOMEOWNER AND/OR THAT AUTHORITY.
- CARRY WORKMAN'S COMPENSATION AND DISABILITY INSURANCE AS REQUIRED BY THE LAW AND ISSUE CERTIFICATE(S) AS REQUIRED BY THE HOMEOWNER AND/OR THE AUTHORITY HAVING JURISDICTION TH APPLICABLE CODES, INCLUDING A CITATION OF THE SPECIFIC CODE PROVISION OR PROVISIONS THAT HAVE NOT BEEN MET.

IT SHALL BE THE DUTY OF THE PERMIT HOLDER TO ASCERTAIN THE RESULTS OF REQUIRED INSPECTIONS.

CONSTRUCTION WORK NOT IN COMPLIANCE WITH APPLICABLE CODES SHALL BE REQUIRED TO REMAIN EXPOSED UNTIL IT HAS BEEN BROUGHT INTO COMPLIANCE WITH THE CODES, RE-INSPECTED, AND FOUND SATISFACTORY AS COMPLETED.

3.0 BUILDING PERMIT:

NO PERSON OR ENTITY SHALL COMMENCE, PERFORM, OR CONTINUE ANY WORK THAT MUST CONFORM WITH THE UNIFORM CODE AND/OR ENERGY CODE UNLESS:

1. SUCH PERSON OR ENTITY HAS APPLIED TO THE TOWN OF GREENWICH FOR A BUILDING PERMIT,
2. THE TOWN OF GREENWICH HAS ISSUED A BUILDING PERMIT AUTHORIZING SUCH WORK,
3. SUCH BUILDING PERMIT HAS NOT BEEN REVOKED OR SUSPENDED, AND
4. SUCH BUILDING PERMIT HAS NOT EXPIRED.

THE BUILDING PERMIT IS REQUIRED TO BE VISIBLY DISPLAYED AT THE WORKSITE AND TO REMAIN VISIBLE UNTIL THE PROJECT, AND ALL REQUIRED INSPECTIONS, HAVE BEEN COMPLETED.

THE APPROVED DRAWINGS MUST BE KEPT AT THE WORKSITE AND BE AVAILABLE FOR REVIEW AT THE TIME OF ANY REQUIRED INSPECTIONS.

4.0 CONSTRUCTION INSPECTIONS:

IT SHALL BE THE DUTY OF THE HOLDER OF THE BUILDING PERMIT, OR THEIR DULY AUTHORIZED AGENT, TO NOTIFY THE BUILDING OFFICIAL WHEN WORK IS READY FOR INSPECTION.

BUILDING DEPARTMENT OF THE TOWN OF GREENWICH.
101 FIELD POINT ROAD
GREENWICH, CT 06830
TEL: (203) 622-7700
EMAIL: bldginsp@greenwichct.org
WEB SITE: www.greenwichct.gov

ANY PERSON OR ENTITY PERFORMING WORK FOR WHICH A BUILDING PERMIT HAS BEEN ISSUED SHALL KEEP SUCH WORK ACCESSIBLE AND EXPOSED UNTIL THE WORK HAS BEEN INSPECTED AND ACCEPTED BY THE AUTHORITY HAVING JURISDICTION, OR ITS AUTHORIZED AGENT, AT EACH ELEMENT OF THE CONSTRUCTION PROCESS THAT IS APPLICABLE TO THE WORK.

BUILDING PERMIT HOLDERS SHALL BE REQUIRED TO NOTIFY THE BUILDING OFFICIAL OF THE TOWN OF GREENWICH WHEN CONSTRUCTION WORK IS READY FOR INSPECTION.

THE BUILDING OFFICIAL SHALL MAKE THE REQUIRED INSPECTIONS OR SHALL HAVE THE AUTHORITY TO ACCEPT WRITTEN REPORTS OF INSPECTION BY APPROVED AGENCIES OR INDIVIDUALS.

REQUIRED INSPECTIONS FOR THIS PROJECT MAY INCLUDE THE FOLLOWING, AS APPLICABLE, OR AS SPECIFIED IN THE CODE ENFORCEMENT PROGRAM OF THE TOWN OF GREENWICH:

- WORKSITE PRIOR TO THE ISSUANCE OF A PERMIT
- PLUMBING*
- ELECTRICAL*
- MECHANICAL
- FRAMING (SUBSEQUENT TO THE INSPECTION & APPROVAL OF PLUMBING, ELECTRICAL & MECHANICAL)
- FIRE RESISTANT CONSTRUCTION
- FIRE RESISTANT PENETRATIONS
- ENERGY CODE COMPLIANCE
- A FINAL INSPECTION AFTER ALL WORK AUTHORIZED BY THE BUILDING PERMIT HAS BEEN COMPLETED
- ANY OTHER INSPECTIONS AS REQUIRED BY THE TOWN OF GREENWICH.

ALL OF THE ABOVE INSPECTION MAY NOT BE REQUIRED FOR THIS, OR ANY GIVEN, PROJECT.

A SCHEDULE OF REQUIRED INSPECTIONS IS AVAILABLE FROM THE BUILDING DEPARTMENT OF THE TOWN OF GREENWICH.

*THE WORK APPLICABLE TO SOME OF THE ABOVE INSPECTIONS (FOR INSTANCE PLUMBING AND ELECTRICAL) SHALL BE COMPLETED UNDER A SEPARATE PERMIT, FILED BY THE RELEVANT LICENSED CONTRACTORS.

AFTER INSPECTION, THE WORK OR A PORTION THEREOF SHALL BE NOTED AS SATISFACTORY AS COMPLETED, OR THE BUILDING PERMIT HOLDER SHALL BE NOTIFIED AS TO THE MANNER IN WHICH THE WORK FAILS TO COMPLY WITH APPLICABLE CODES, INCLUDING A CITATION OF THE SPECIFIC CODE PROVISION OR PROVISIONS THAT HAVE NOT BEEN MET.

IT SHALL BE THE DUTY OF THE PERMIT HOLDER TO ASCERTAIN THE RESULTS OF REQUIRED INSPECTIONS.

CONSTRUCTION WORK NOT IN COMPLIANCE WITH APPLICABLE CODES SHALL BE REQUIRED TO REMAIN EXPOSED UNTIL IT HAS BEEN BROUGHT INTO COMPLIANCE WITH THE CODES, RE-INSPECTED, AND FOUND SATISFACTORY AS COMPLETED.

STRUCTURAL STEEL:

STRUCTURAL STEEL MEMBERS:
STRUCTURAL STEEL SHAPES SHALL CONFORM TO THE FOLLOWING SPECIFICATIONS:

1. W-SHAPES: ASTM A992 (F_y = 50-65 KSI, F_u = 65 KSI)
2. M-, S- & HP-SHAPES: ASTM A36 (F_y = 36 KSI, F_u = 58-80 KSI)
3. CHANNELS (C & MC): ASTM A36 (F_y = 36 KSI, F_u = 58-80 KSI)
4. ANGLES (L): ASTM A36 (F_y = 36 KSI, F_u = 58-80 KSI)
5. STRUCTURAL TEES: SAME AS (THEIR) M-, S- & W-SHAPES
6. RECTANGULAR & SQUARE HSS: ASTM A500 GRADE B (F_y = 46 KSI, F_u = 58 KSI)
7. ROUND HSS: ASTM A500 GRADE B (F_y = 42 KSI, F_u = 58 KSI)
8. STEEL PIPE: ASTM A53 GRADE B (F_y = 35 KSI, F_u = 60 KSI)
9. PLATES & BARS (UP TO 8"): ASTM A36 (F_y = 36 KSI, F_u = 58-80 KSI)
10. PLATES & BARS (> 8"): ASTM A36 (F_y = 32 KSI, F_u = 58 KSI)

FASTENING PRODUCTS:
FASTENING PRODUCTS SHALL CONFORM TO THE FOLLOWING SPECIFICATIONS:

1. H.S. A325 BOLTS: >1"-1 1/2" INC.: ASTM A325 (F_u = 120 KSI)
H.S. A325 BOLTS: 1/2" - 1" INC.: ASTM A325 (F_u = 105 KSI)
2. H.S. A490 BOLTS: 1/2" - 1 1/2" INC.: ASTM A490 (F_u = 150 KSI)
3. HEAVY-DUTY HEX NUTS: 1/2" - 4": ASTM A563
4. HARDENED WASHERS: 1/2" - 4": ASTM F436
5. H.S. A490 BOLTS: 1/2" - 1 1/2" INC.: ASTM A490 (F_y = XX KSI, F_u = 150 KSI)
6. THREADED ROD: ASTM A36 (F_y = 36 KSI, F_u = 58-80 KSI)
7. ANCHOR ROD: ASTM F1554, GR. 36 (F_y = 36 KSI, F_u = 58-80 KSI)
8. FILLER (WELD) MATERIAL: PER TABLE D1.1 TABLE 3.1 (MINIMUM F_u = 70KSI)
9. WELDING ELECTRODES: E70XX RODS TO AWS A5.20 (FCA PROCESS)
OR AWS A5.18, (GMAW PROCESS)
OR AWS A5.1 (GMAW PROCESS)

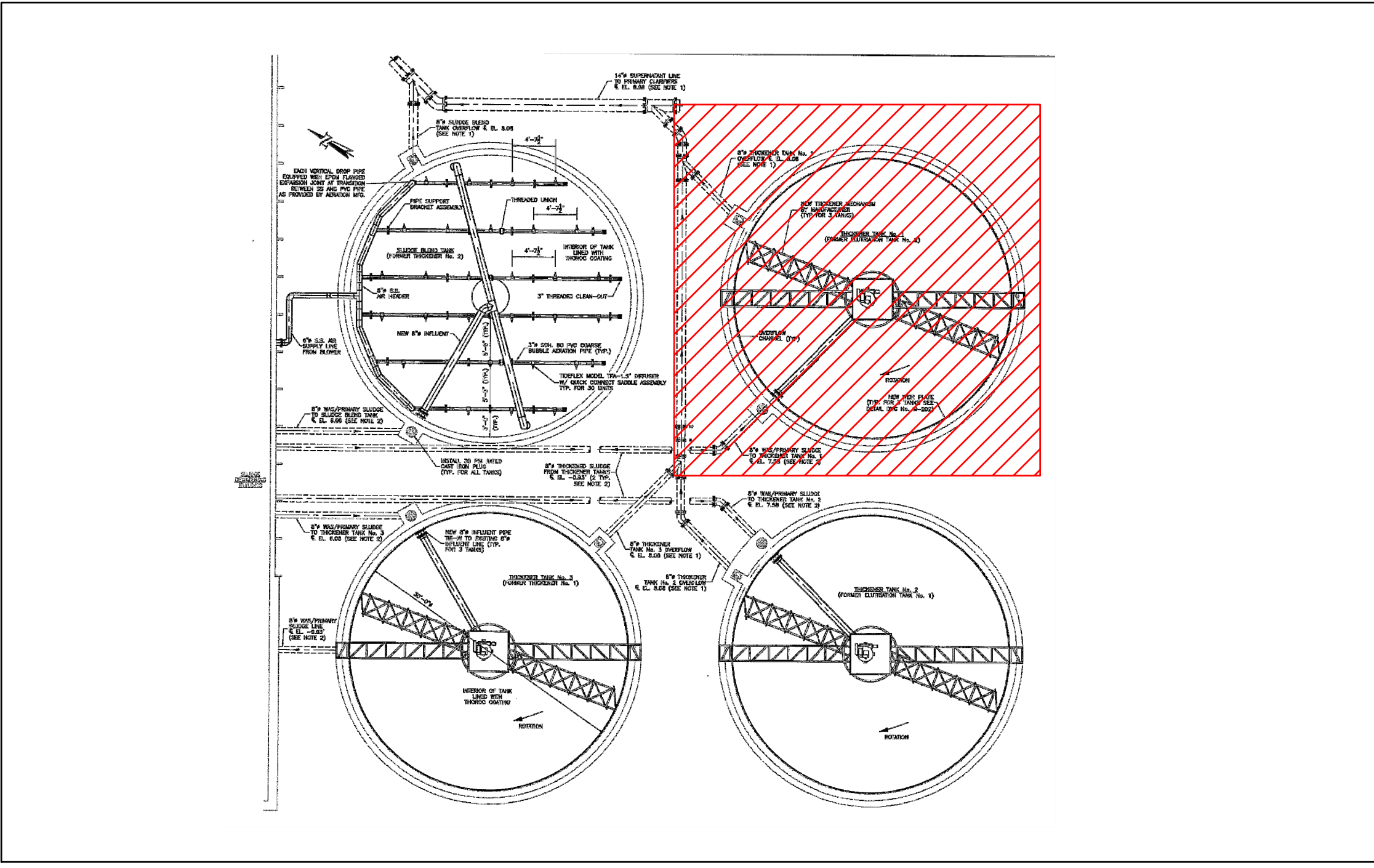

PROPOSED WORK
CLIENT-PROVIDED IMAGE
NOT TO SCALE

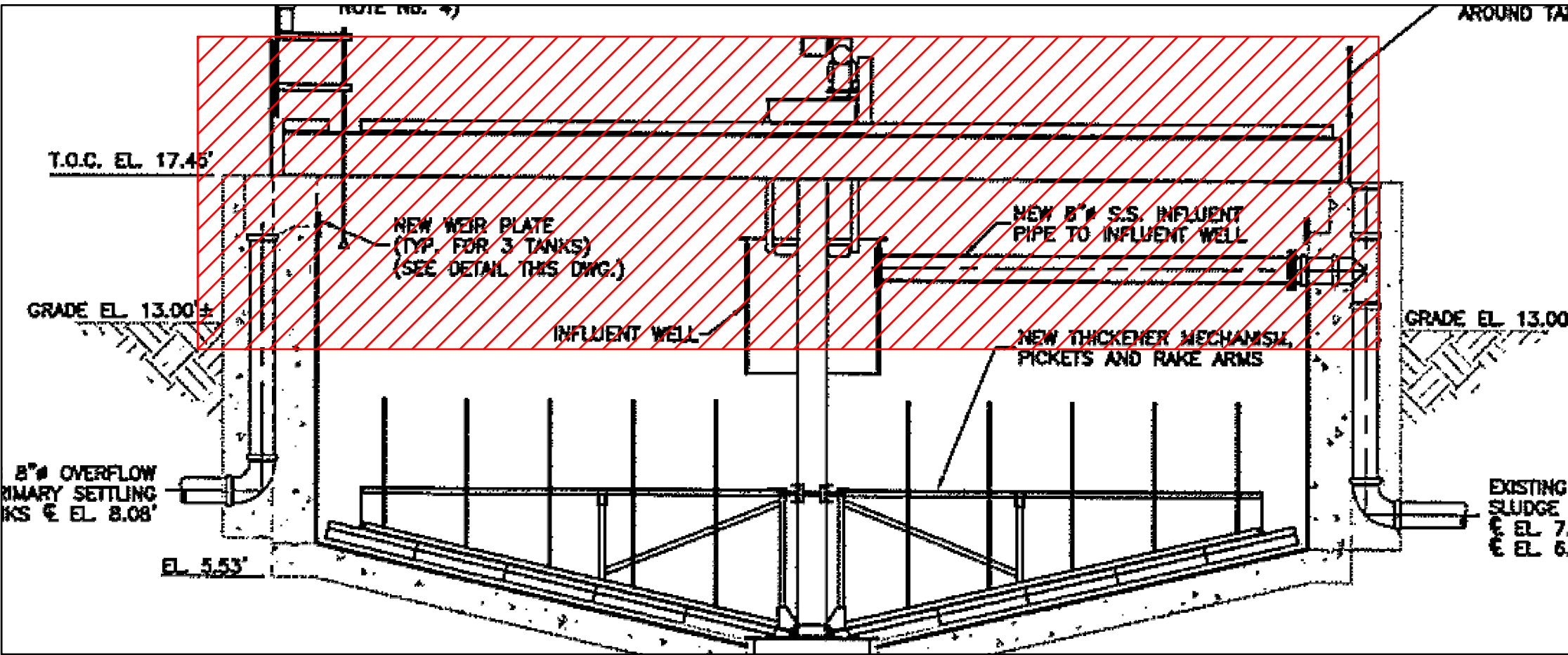

TYPICAL THICKENER TANK SECTION
CLIENT-PROVIDED IMAGE
NOT TO SCALE

SAMPLE ONLY
NOT FOR REPRODUCTION
OR UNAUTHORIZED USE

STATEMENT OF DESIGN PROFESSIONAL:

THESE PLANS HAVE BEEN PREPARED IN CONFORMANCE WITH THE 2021 INTERNATIONAL BUILDING CODE PORTION OF THE 2022 CONNECTICUT STATE BUILDING CODE (INTERNATIONAL BUILDING CODE 2021 WITH AMENDMENTS).

VINCENT D'AMICO, P.E.
(SEAL AND SIGNATURE)

LIST OF DRAWINGS

SHEET	DRAWING NAME	DATE	REVISION
C-01	COVER SHEET	02.05.2025	03.07.2025
S-01	LAYOUT	02.05.2025	03.07.2025
S-02	DETAILS	02.05.2025	03.07.2025

PROPERTY ADDRESS:

GREENWICH, CT 06830
(TOWN OF GREENWICH
BUILDING DEPARTMENT)

TAX ID:

CLIENT:

*** ***

TEL:

EMAIL:

DATE:

02.05.2025

ISSUE:

PRELIMINARY
FOR REVIEW

PROJECT NAME:

RETROFIT THICKENER TANK
STRUCTURE

DRAWING NAME:

COVER SHEET

DRAWING NUMBER:

C-01

DATE:

03.07.2025

SCALE:

AS NOTED

NOTE:

THIS DRAWING IS VALID FOR
CONSTRUCTION IF (AND ONLY IF) A
PERMIT IS ISSUED, BASED ON THIS
DRAWING, BY THE TOWN OF
GREENWICH.

Oliver Engineering, P.C.
Design - Permit Applications - Legalizations
Code Compliance - Project Supervision
188 North Main Street | Port Chester, NY 10573
(914) 774-5878 | www.proeng.nyc | vc@proeng.nyc

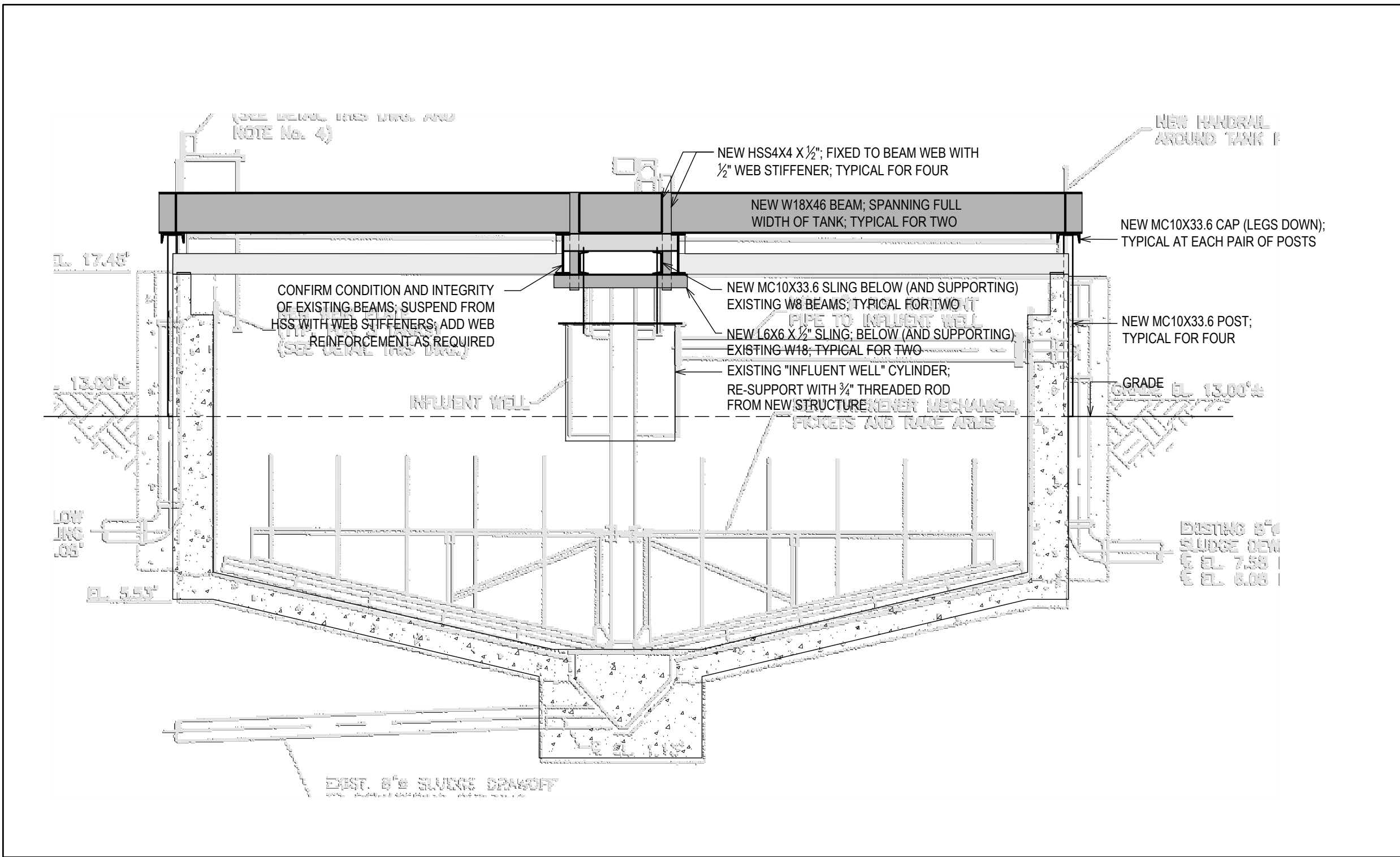

SECTION A
VERIFY ALL CONDITIONS IN FIELD
1/4" = 1'-0"

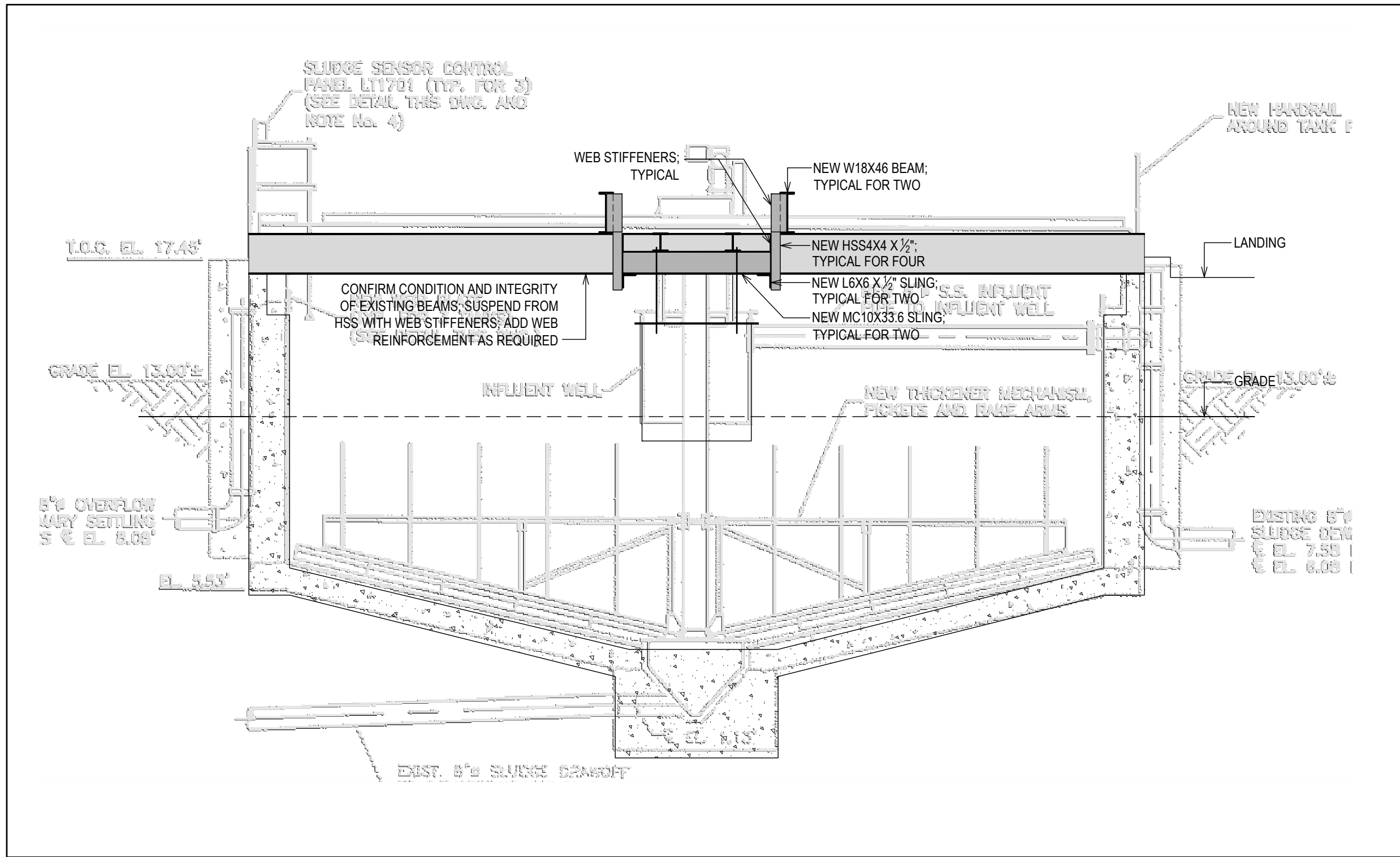

SECTION B
VERIFY ALL CONDITIONS IN FIELD
1/4" = 1'-0"

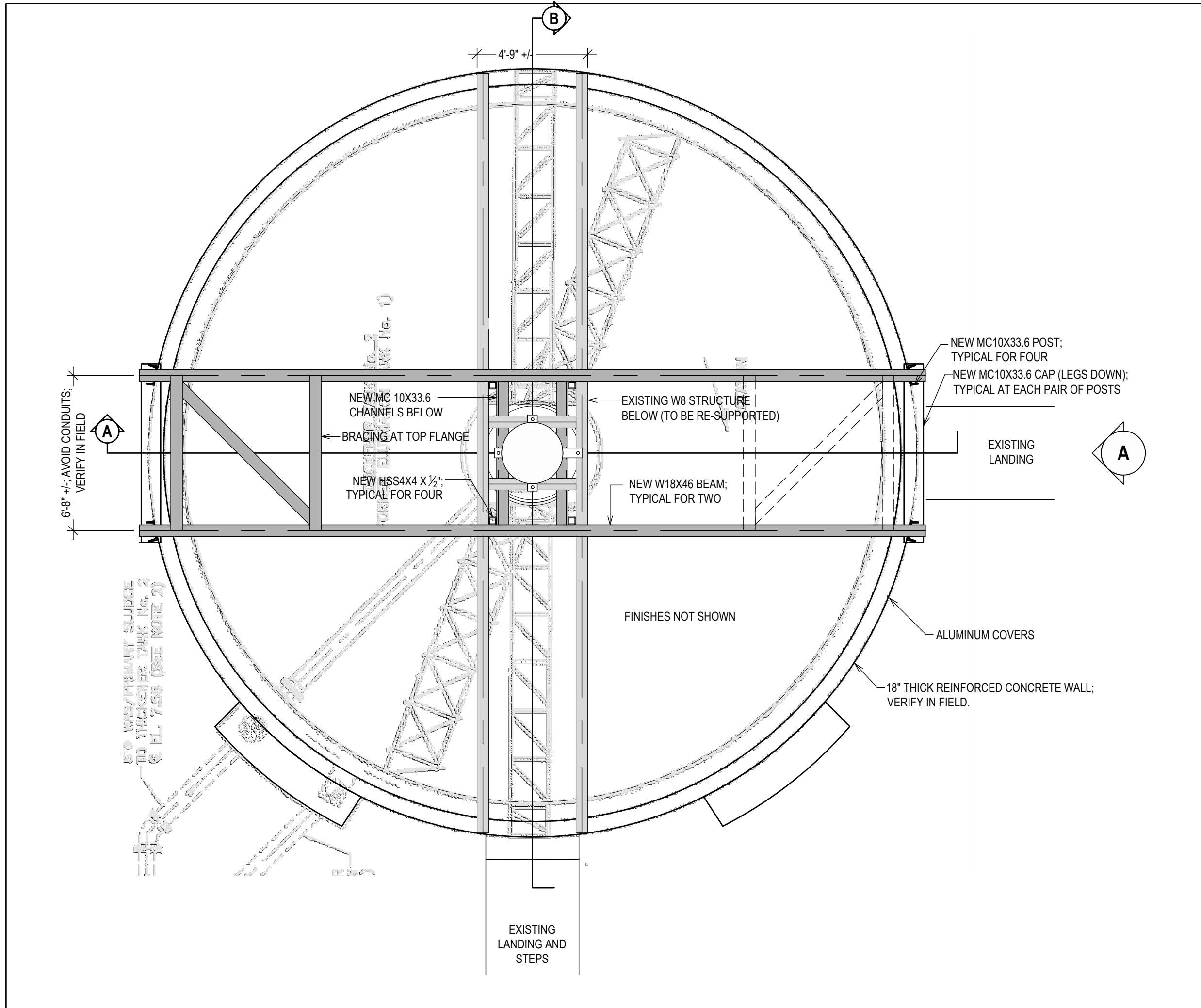

PLAN
VERIFY ALL CONDITIONS IN FIELD
1/4" = 1'-0"

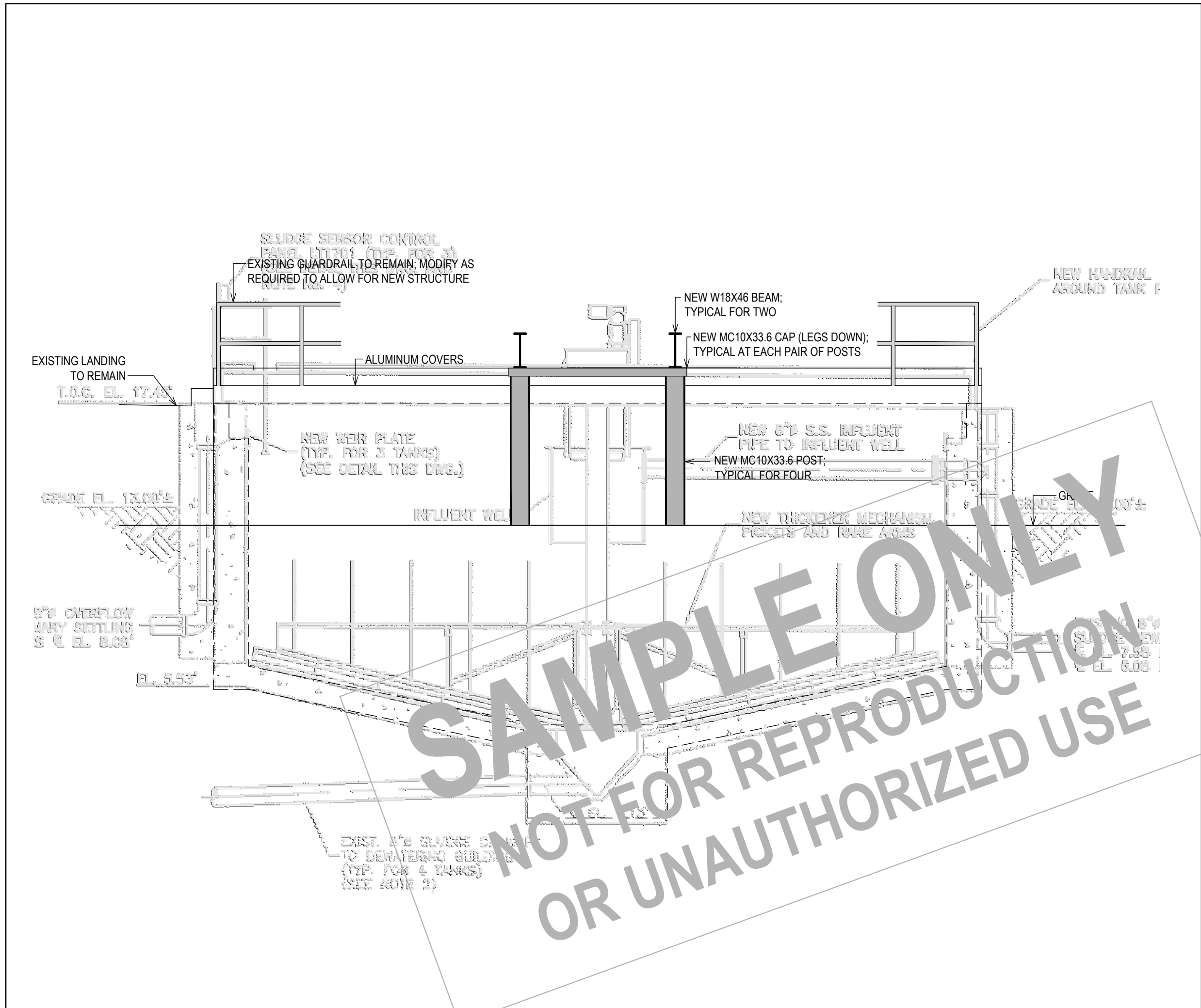

ELEVATION A
VERIFY ALL CONDITIONS IN FIELD
1/4" = 1'-0"

PROPERTY ADDRESS:

GREENWICH, CT 06830
(TOWN OF GREENWICH
BUILDING DEPARTMENT)

TAX ID:

CLIENT:

TEL: ***

EMAIL: ***

DATE:

02.05.2025

ISSUE:

PRELIMINARY
FOR REVIEW

PROJECT NAME:

RETROFIT THICKENER TANK
STRUCTURE

DRAWING NAME:

LAYOUT

DRAWING NUMBER:

S-01

DATE:

03.07.2025

SCALE:

AS NOTED

NOTE:

THIS DRAWING IS VALID FOR
CONSTRUCTION IF (AND ONLY IF) A
PERMIT IS ISSUED, BASED ON THIS
DRAWING, BY THE TOWN OF
GREENWICH.

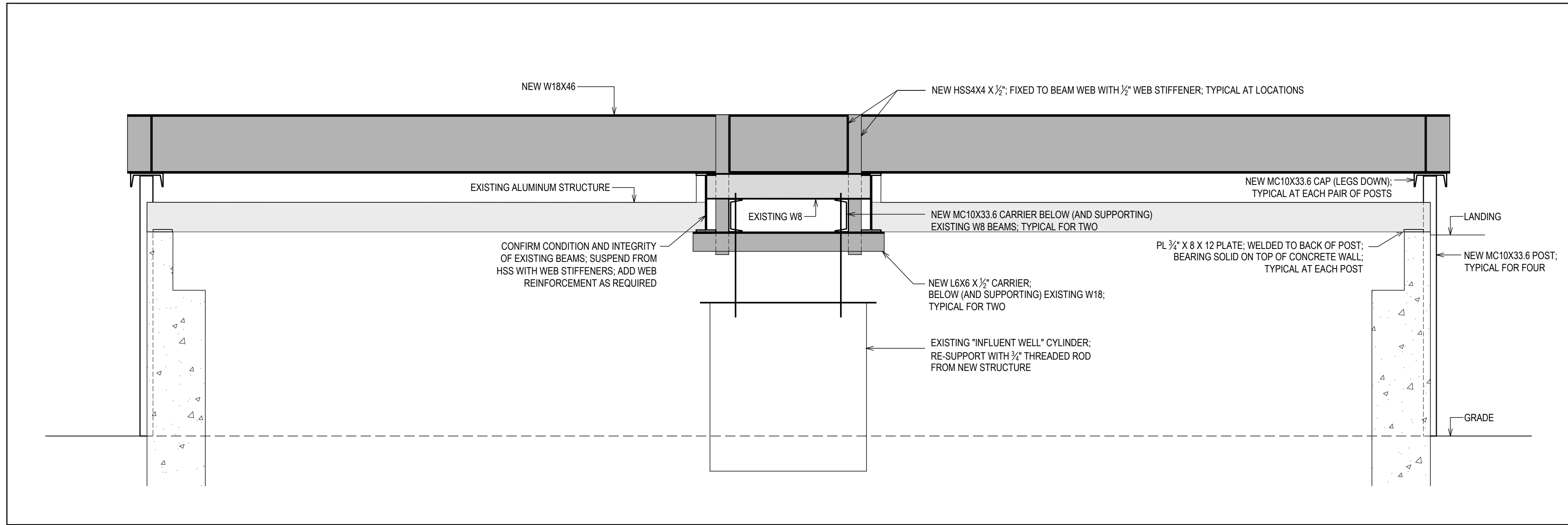

SECTION A
VERIFY ALL CONDITIONS IN FIELD
1/2" = 1'-0"

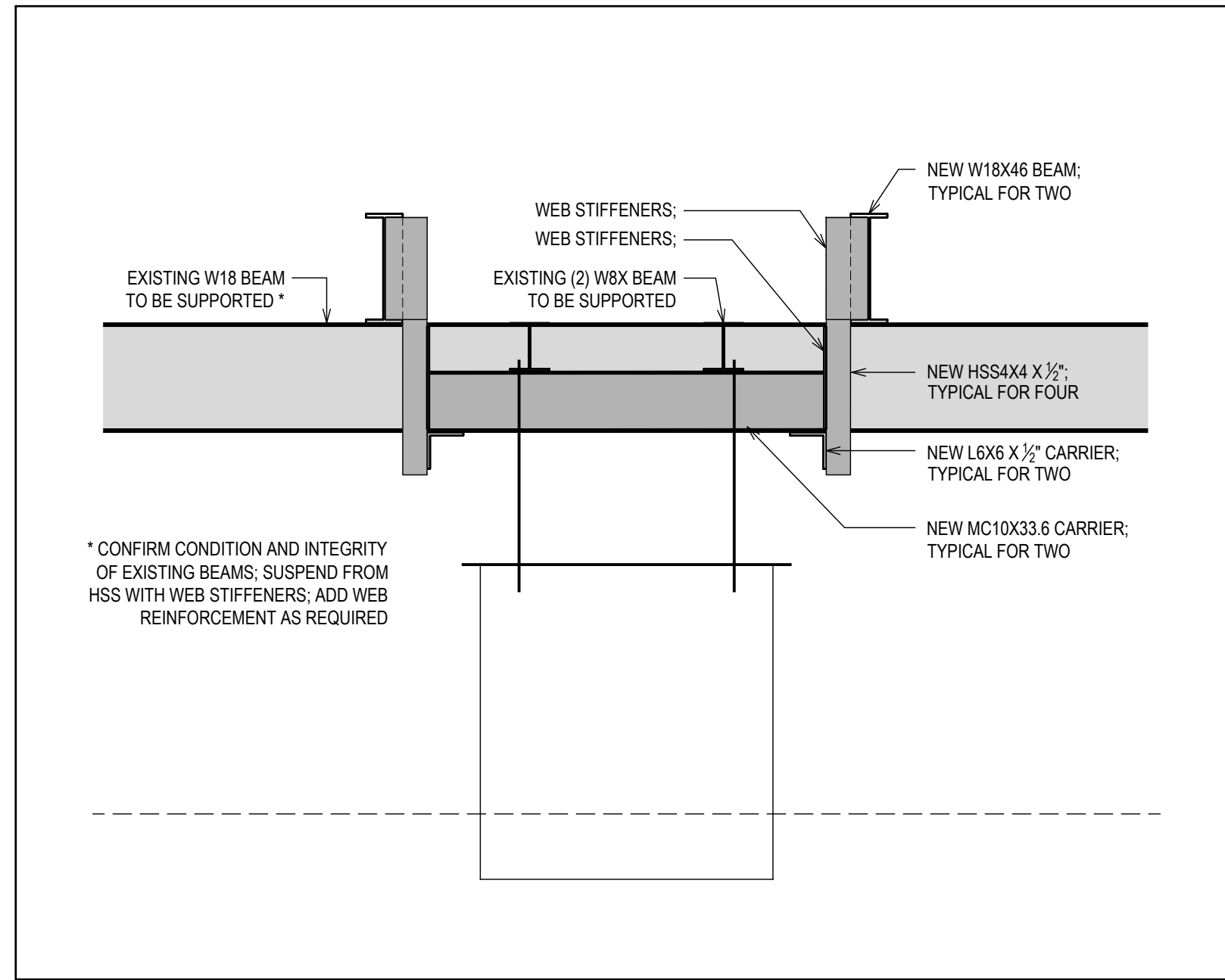

SECTION B
VERIFY ALL CONDITIONS IN FIELD
1/2" = 1'-0"

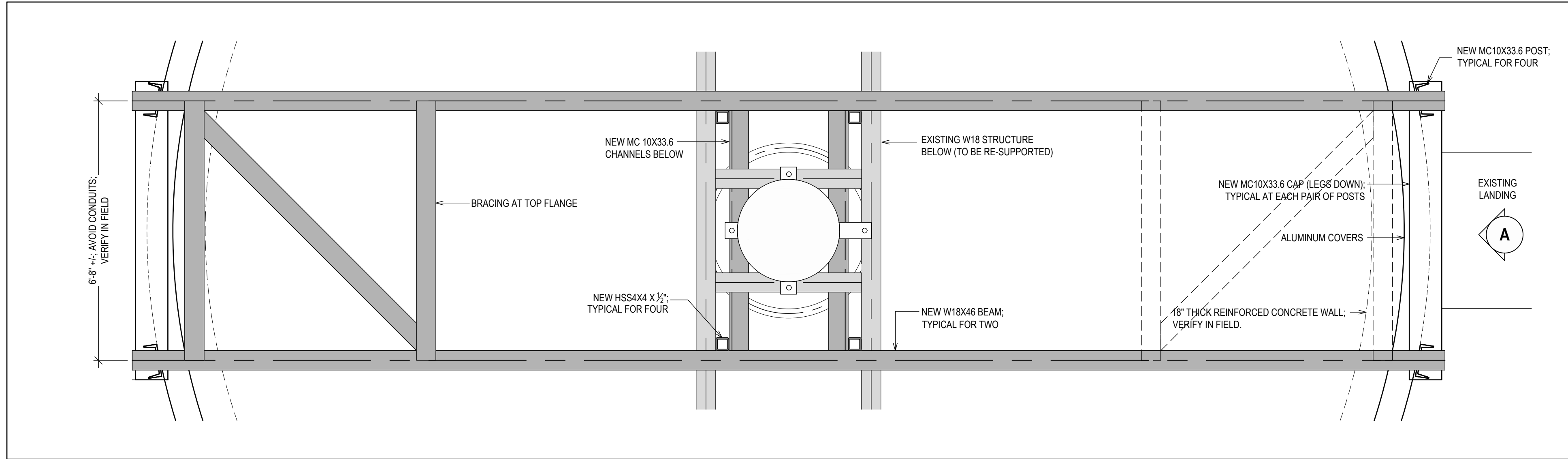

PLAN
VERIFY ALL CONDITIONS IN FIELD
1/2" = 1'-0"

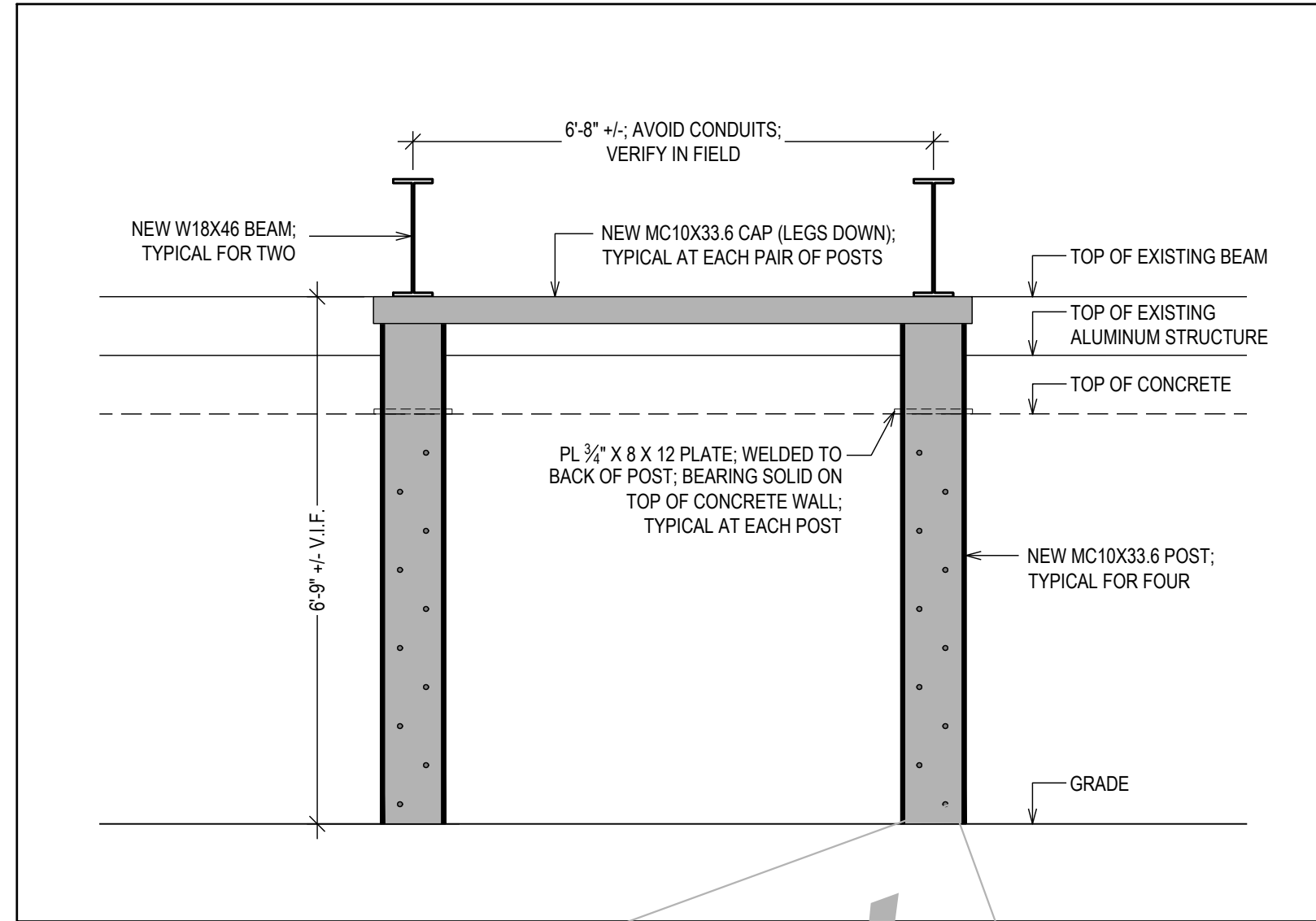

ELEVATION A
VERIFY ALL CONDITIONS IN FIELD
1/2" = 1'-0"

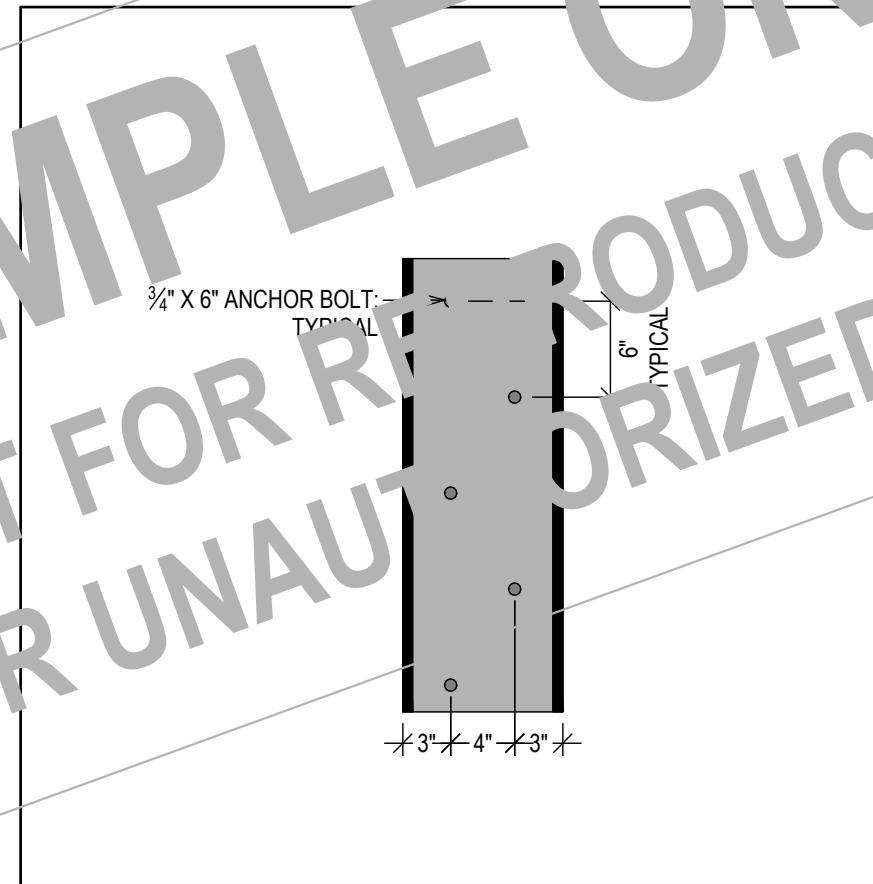

POST DETAIL
VERIFY ALL CONDITIONS IN FIELD
1" = 1'-0"

PROPERTY ADDRESS:

GREENWICH, CT 06830
(TOWN OF GREENWICH
BUILDING DEPARTMENT)

TAX ID:

CLIENT:
*** **

TEL: ***
EMAIL: ***

DATE: 02.05.2025
03.07.2025
ISSUE: PRELIMINARY
FOR REVIEW

PROJECT NAME:
RETROFIT THICKENER TANK
STRUCTURE

DRAWING NAME:
DETAILS

DRAWING NUMBER:
S-02

DATE:
03.07.2025

SCALE:
AS NOTED

NOTE:
THIS DRAWING IS VALID FOR
CONSTRUCTION IF (AND ONLY IF) A
PERMIT IS ISSUED, BASED ON THIS
DRAWING, BY THE TOWN OF
GREENWICH.